



808 Champion Swivels

Designed specifically for underground and overhead cable pulling applications. Can handle all types of utility cables. Precision machined from high-strength stainless steel. Clevis pin is easily replaceable (see ordering information below).

CAUTION: 808 Champion Swivels are to be used for cable stringing or pulling only. 808 Champion Swivels are not to be used for directional drilling.

NOTE: Swivels are not designed to run around bullwheels. Always verify that the swivel size is sized to the pulling harness or grip prior to ordering.

Not Designed for Directional Drilling.

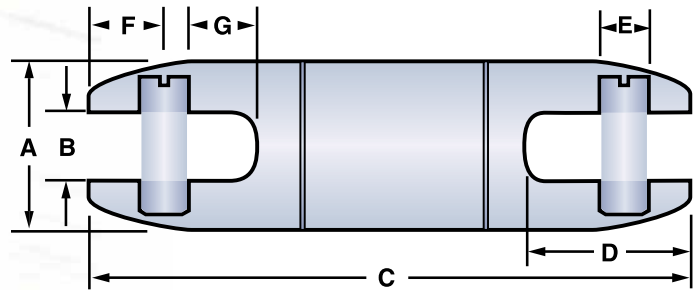

Part Number	Working Load		Aerial		A (in)	A (mm)	B (in)	B (mm)	C (in)	C (mm)	D (in)	D (mm)	E (in)	E (mm)	F (in)	F (mm)	G (in)	G (mm)
	*Underground (lbs.)	(N)	**Aerial (lbs.)	(N)														
08017000	600	2,669	360	1,601	5/8	16	.28	7	3.56	90	.79	20	.25	6	.37	9	.295	7
08016000	2,500	11,120	1,500	6,672	7/8	22	.38	10	4.51	115	1.06	27	.31	8	.53	13	.375	10
08016000H***	2,500	11,120	1,500	6,672	7/8	22	.38	10	4.51	115	1.06	27	.31	8	.53	13	.375	10
08080912	5,000	22,241	3,000	13,344	1 1/4	32	.56	14	5.44	138	1.34	34	.37	9	.59	15	.565	14
08080912H***	5,000	22,241	3,000	13,344	1 1/4	32	.56	14	5.44	138	1.34	34	.37	9	.59	15	.565	14
08080913	7,000	31,137	4,200	18,682	1 3/8	35	.56	14	5.25	133	1.31	33	.44	11	.56	14	.530	13
08080913H***	7,000	31,137	4,200	18,682	1 3/8	35	.56	14	5.25	133	1.31	33	.44	11	.56	14	.530	13
08080916	10,000	44,482	6,000	26,689	1 1/2	41	.63	16	6.51	165	1.59	40	.56	14	.78	20	.530	13
08080916H***	10,000	44,482	6,000	26,689	1 1/2	41	.63	16	6.51	165	1.59	40	.56	14	.78	20	.530	13
08080920	15,000	66,723	9,000	40,033	2	51	.75	19	6.99	178	1.78	45	.62	16	.72	18	.750	18
08080920H***	15,000	66,723	9,000	40,033	2	51	.75	19	6.99	178	1.78	45	.62	16	.72	18	.750	18
08080925	25,000	111,205	15,000	66,723	2 1/2	64	1.00	25	10.23	260	2.80	71	.87	22	1.23	31	1.135	29
08080925H***	25,000	111,205	15,000	66,723	2 1/2	64	1.00	25	10.23	260	2.80	71	.87	22	1.23	31	1.135	29
08080930	30,000	133,446	18,000	80,068	3	76	1.31	33	12.04	306	3.56	90	1.12	28	1.37	35	1.630	41

* 3:1 Safety Factor

** 5:1 Safety Factor

*** Comes standard with hex head clevis pin.



Replacement Clevis Pins for 808 Champion Swivels

Part Number	Replacement Part Number, Slotted	Part Number	Replacement Part Number, Hex
08017000	08017016		
08016000	08955408	08016000H	08081065
08080912	08081046	08080912H	08081042
08080913	08081036	08080913H	21000371
08080916	08081026	08080916H	21000381
08080920	08081016	08080920H	21000391
08080925	08081006	08080925H	21000401
08080930	08081053		

821 Champion Swivels

Designed to meet common dimensional specifications, the 821 Champion Swivels are designed for underground and overhead cable pulling applications and can handle all types of utility cable. Precision machined stainless steel. Clevis pin is easily replaceable (see ordering information below).

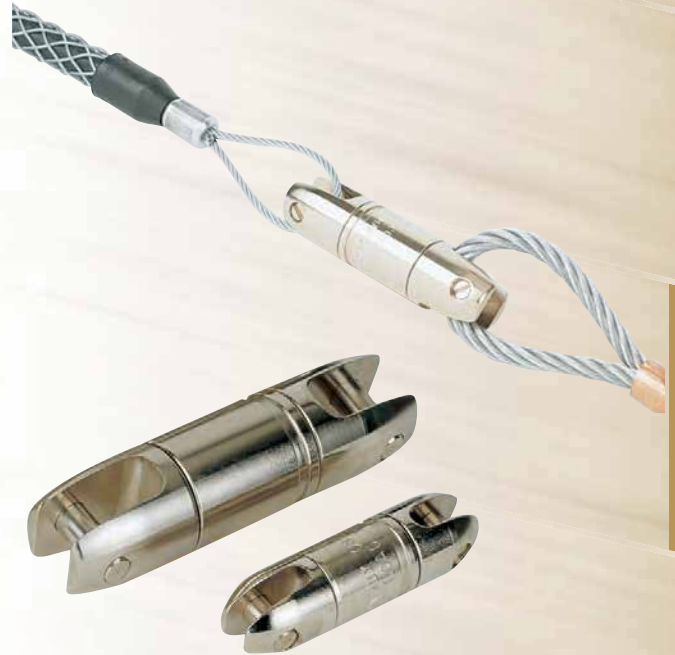
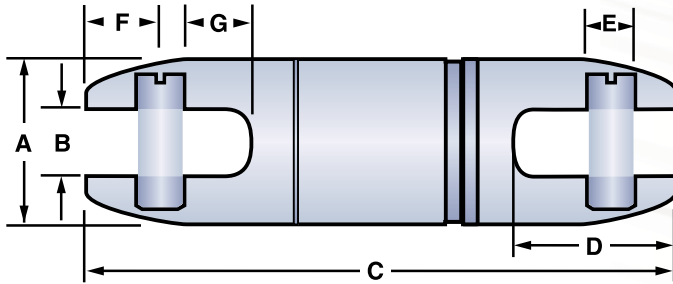

SWIVELS & ACCESSORIES

CAUTION: To be used for cable stringing or pulling only.

NOTE: Swivels are not designed to run around bullwheels.

Part Number	*Underground		**Aerial		A		B		C		D		E		F		G	
	(lbs.)	(N)	(lbs.)	(N)	(in)	(mm)	(in)	(mm)	(in)	(mm)	(in)	(mm)	(in)	(mm)	(in)	(mm)	(in)	(mm)
08210007	1,800	8,006	1,080	4,804	7/8	22	.31	8	3.09	78	.84	21	.31	8	.38	10	0.305	8
08210012	4,000	17,792	2,400	10,675	1 1/4	32	.59	15	4.52	115	1.22	31	.38	10	.44	11	0.410	10
08210014	7,500	33,360	4,500	20,016	1 1/16	37	.59	15	5.13	130	1.41	36	.44	11	.59	15	0.600	15
08210018	10,000	44,480	6,000	26,689	1 7/8	48	.75	19	7.06	179	1.88	48	.63	16	.81	21	0.755	19

* 3:1 Safety Factor
** 5:1 Safety Factor

Replacement Clevis Pins for 821 Champion Swivels

Part Number	Replacement Part Number
08210007	08210105
08210012	08210115
08210014	08210125
08210018	08210135