



U.S. Patent No. 5,607,248.

819 D.Drill® Directional Drilling Swivels

Designed specifically for directional drilling, the Condux 819 D.Drill Swivels prevent boring equipments' rotational torque from interfering with the product (cable or conduit) being pulled. The D.Drill Swivels are greasable and double sealed to keep contaminants out. Clevis pins with hex nuts allow for installation and removal from either side of the swivel. There is a 90 day warranty on the directional drill swivels.

CAUTION: To be used for directional drilling only.

CAUTION: Condux requires the use of a calcium based lubricant only. Other lubricants may have adverse reactions when exposed to bentonite products. Condux requires that the swivels be flushed with grease after each use to purge any contaminants that may have penetrated past the seals into the swivel while boring. See page 56 for calcium based lubricants.

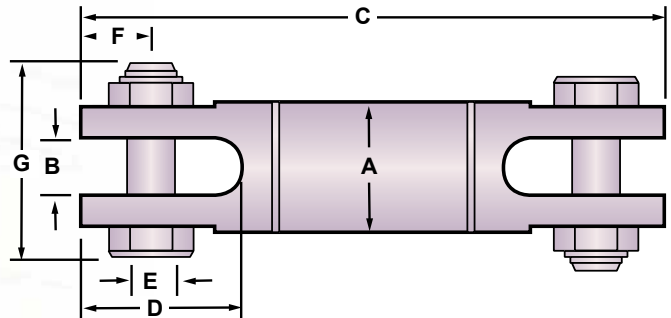

Part Number	Working Load				A		B		C		D		E		F		G	
	Tension (lbs)	Tension (N)	Compression (lbs)	Compression (N)	(in)	(mm)	(in)	(mm)	(in)	(mm)	(in)	(mm)	(in)	(mm)	(in)	(mm)	(in)	(mm)
08190016	8,500	37,808	2,800	12,454	1 ⁵ / ₈	41	.63	16	6.85	174	1.59	40	.56	14	.78	20	2.36	60
08190020	10,000	44,480	3,300	14,678	2	51	.75	19	7.83	199	1.81	46	.63	16	.75	19	2.89	73
08190025	20,000	88,960	6,600	29,357	2 ¹ / ₂	64	1.00	25	10.93	278	2.84	72	.88	22	1.25	32	3.67	93
08190030	30,000	133,440	10,000	44,480	3	76	1.31	33	12.75	324	3.56	90	1.13	29	1.37	36	4.50	114
08190040	45,000	200,160	15,000	66,720	4	102	1.63	41	15.25	387	4.00	102	1.25	32	1.84	47	5.58	142
08190045	60,000	266,880	20,000	88,960	4 ³ / ₈	117	1.75	44	17.48	444	4.62	117	1.50	38	2.13	54	6.31	160
08190060	90,000	400,320	30,000	133,440	6	152	2.00	51	18.27	464	4.50	114	1.75	44	2.18	56	6.59	167
08190080	120,000	533,760	40,000	177,920	8	203	2.25	57	21.71	552	5.25	133	2.00	51	2.50	64	8.25	210

819 D.Drill® Replacement Parts



Swivel Size	Clevis Pin	Locking Nut
1 5/8 (41 mm)	08190104	02250500
2 (51 mm)	08190114	02250600
2 1/2 (64 mm)	08190124	02250700
3 (76 mm)	08190134	02250800
4 (102 mm)	08190154	02263000
4 5/8 (117 mm)	08190144	02250900
6 (152 mm)	08190164	02251000
8 (203 mm)	08190167	02279000